

Permit # \_\_\_\_\_

Name \_\_\_\_\_

\_\_\_\_\_

\_\_\_\_\_

*EXAMPLE of a SITE PLAN*

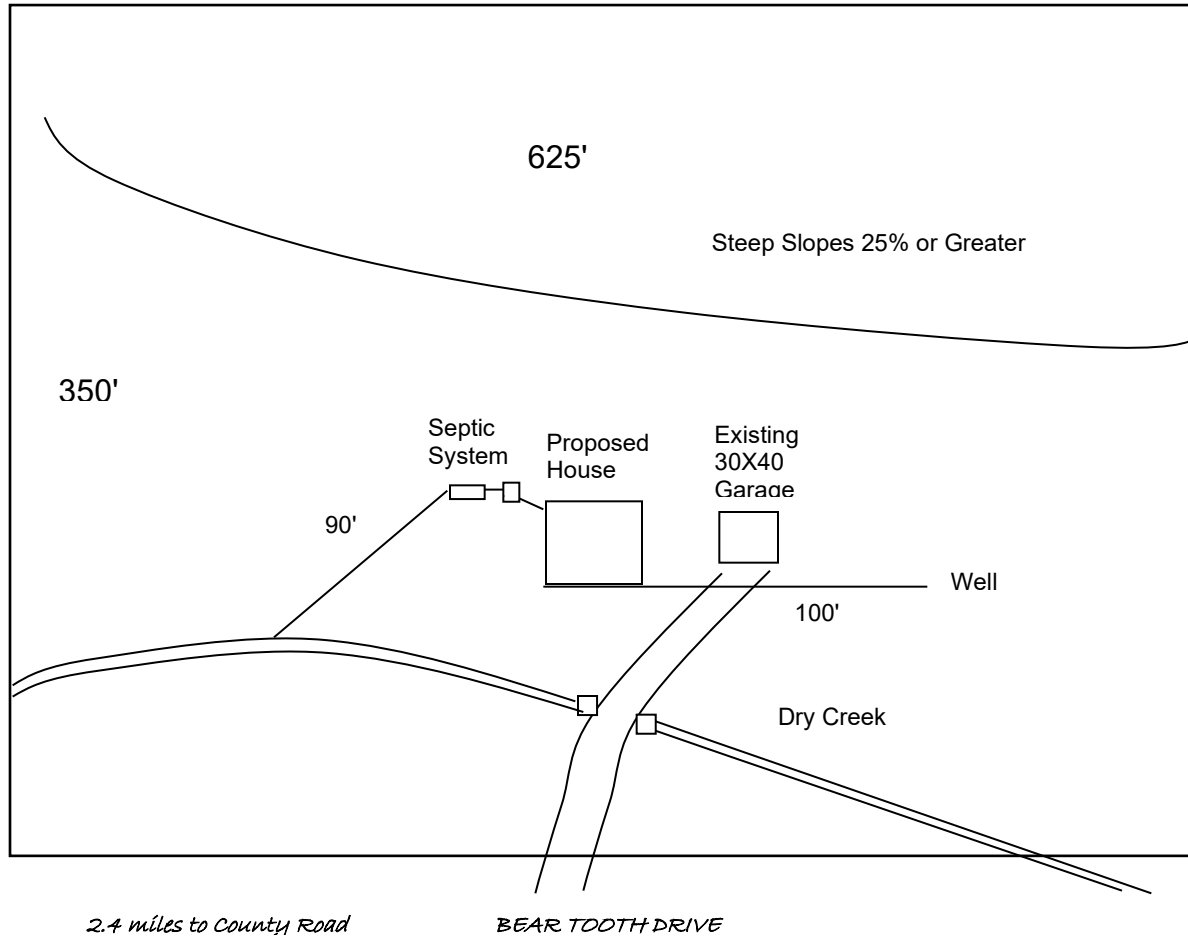

---

---

# Fergus County Planning Office

## Development Permit Application Form



712 West Main Suite 101  
Lewistown, MT 59457

Phone: 406-535-9046

E-Mail  
[pvoesen@co.fergus.mt.us](mailto:pvoesen@co.fergus.mt.us)

---

---

Anyone proposing to build a residential or commercial structure in Fergus County should first obtain a Development Permit. The purpose of this permit is to identify any property, road, or floodplain limitations prior to the start of construction and to assign a physical address for emergency purposes.

**Application Information**

Applicant \_\_\_\_\_

Phone \_\_\_\_\_

Mailing Address \_\_\_\_\_

Proposed Construction, including outbuildings \_\_\_\_\_

Township \_\_\_\_\_ Range \_\_\_\_\_ Section \_\_\_\_\_

Subdivision and Lot# (if applicable) \_\_\_\_\_

Driveway located on what road name? \_\_\_\_\_

Nearest address to your construction site? \_\_\_\_\_

**\*\*Stake driveway & residence location\*\***

A site plan (see back) must accompany this application, drawn reasonably to scale on an 8.5" x 11" piece of paper. The site plan must show all existing & proposed construction, bodies of water, driveways, wells, & septic systems. The fee of \$25.00 must also accompany the application. Permits received after construction begins will be assessed a \$50.00 fee.

**Signature** \_\_\_\_\_

**Date** \_\_\_\_\_

**OFFICIAL USE ONLY**

Floodplain Permit? \_\_\_\_ Yes \_\_\_\_ No

Septic Permit? \_\_\_\_ Yes \_\_\_\_ No

Approach Permit? \_\_\_\_ Yes \_\_\_\_ No

Physical Address assigned to structure \_\_\_\_\_

Mail Delivery \_\_\_\_\_

COMMENTS: \_\_\_\_\_

**Final Action**

\_\_\_\_\_ Approved \_\_\_\_\_ Denied

Reviewed By: \_\_\_\_\_

Date: \_\_\_\_\_

**YOU ARE RESPONSIBLE FOR ALL ADDITIONAL PERMITS**

Contact the MT State Building Codes Department for required state permits for all building in Fergus County.

**CONTACTS**

Fergus County Planning Office  
Courthouse Suite 101  
(Floodplain, Development & Encroachment permits)  
(406) 535-9046

DNRC – Water rights and well info  
(406-538-7401)

Fergus County Health Department -  
(Septic permits & lot layout changes)  
(406) 380-0952

Fergus County Road & Bridge  
Department (encroachment permits)  
(406) 535-5006

State Building, Electrical, Plumbing,  
Mechanical Inspections, and Permits  
(406) 841-2056

MDOT, Highway Approach Permits  
(406) 657-0240

Fergus Electric Cooperative, Inc.  
(406) 538-3465

NorthWestern Energy  
New Construction 800-371-8666  
Underground Line Locating 800-424-5555